

# Instruction Manual

## Smart Door/Window Sensor

### Zigbee 3.0

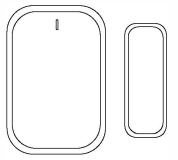

English

ZSS-S01-GWM-C-M9-DC06

Bitte scannen Sie den QR-Code, um das deutsche Handbuch, das Installationsvideo und die Funktionseinführung zu erhalten

Escanee el código QR para obtener el manual en español, el video de instalación y la introducción de la función

Veuillez scanner le code QR pour obtenir le manuel en français, la vidéo d'installation et l'introduction des fonctions

Отсканируйте QR-код, чтобы получить руководство на русском языке, видео по установке и описание функций

Scansionare il codice QR per ottenere il manuale in italiano, il video di installazione e la guida alle funzionalità

Leia o código QR para obter o manual em português, o vídeo de instalação e a introdução das funções

Zeskanuj kod QR, aby uzyskać instrukcje, filmy instalacyjne i funkcje

من فضلك اترك مربع رمز التوجيه العربية (QR) للحصول على دليل المستخدم باللغة العربية وأيضاً الفيديو ورسالة ترحيب

請掃描二維碼獲取中文說明書、安裝視頻及功能介紹



### Product Introduction

Smart Door/Window Sensor senses the opening and closing status of doors and windows by detecting the proximity and separation of magnets. Alarm information can be uploaded through Zigbee protocol in wireless IOT mode. Records can be uploaded to realise the security detection of the monitored objects. This product is suitable for home residence, building villa, factory, shopping mall, office building and so on.

### Packing List

- Door/Window Sensor \*1
- Product user manual \*1
- Battery \*1
- Double-sided sticker \*2

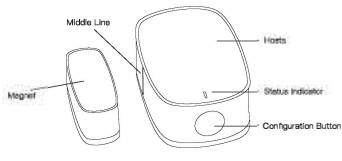

\*Make sure the side of the magnet with marked line is aligned to the side of the hosts marked with the Middle line.

### Technical Parameters

Model	ZSS-GWM-C
Product Name	Smart Door/Window Sensor
Wireless Connection	Zigbee
Support Low Battery Alarm	Yes
Operating Temperature	-10°C ~ +50°C
Alarm Trigger Distance	20±5mm
Battery Specifications	CR2032 (replaceable)
Product Size	Host: 40*26*13 mm Magnet: 26*9.5*11 mm
Frequency Band	2.405-2.480GHz
Maximum Radio Transmit Power	<=10dBm

### Installation Instructions

The product can be applied to the door, window and other scenes, please install the host and the magnet separately on the fixed door frame or window, as shown in the following figure:

Mounting position for reference only (Use Double-sided sticker for fixing)

- Do not install outdoors, on a weak foundation, or in a location subject to rain.
- Do not place magnetic metals or other objects to avoid interfering with the sensor's work.

### Preparation for Use

1. Download MOES App on App store or scan the QR code



MOES App is upgraded as much more compatibility than Tuya Smart/Smart Life App, functional well for scenes controlled by Siri, widget and scene recommendations as the fully new customized service.

(Note: Tuya Smart/Smart Life App still works, but MOES App is highly recommended)

### 2. Registration or Log in

- Download "MOES" Application.
- Enter the Register/Login Interface, tap "Register" to create an account by entering your phone number to get verification code and "Set password." Choose "Log in" if you already have a MOES account.

### Add device

1. Slide the rear cover towards the direction of the arrow, remove the rear cover, then remove the insulation sheet and finally reinstall the rear cover.

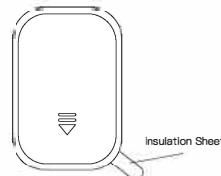

Remove insulation sheet to power on the sensor.

### 2. Open the MOES APP, make sure the ZigBee gateway/multi gateway is connected to the APP, enter the gateway and click "Add New Device".

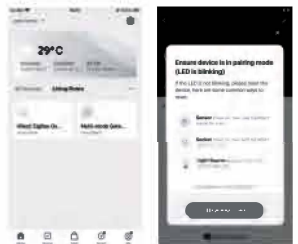

### 3. Enter configuration mode

① Press and hold the "button" for more than 6 seconds until the white indicator light flashes quickly, and the sensor enters pairing mode. (Note: When configuring the network, please make the device as close as possible to the gateway.)

② If the network configuration fails, press and hold the device button again until the white light flashes quickly, and repeat the above operations.

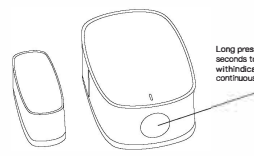

### 4. Wait for 10-120 seconds. After adding the device successfully, you can edit the device name



### 5. Now you can set "smart scene linkage" according to your needs and enjoy your smart home life.



### Restriction of elements or element identification tables

Part Name	Toxic and hazardous substances or elements					
	Lead (Pb)	Mercury (Hg)	Chromium (Cd)	Hexavalent chromium (Cr(VI))	Deoxyphenyl ether (PBB)	Diarylophenyl ether (PBDE)
LED	○	○	○	○	○	○
Control Board	X	○	○	○	○	○
Housings and other components	X	○	○	○	○	○

This form has been prepared in accordance with the provisions of SJ/T 11364.

○ indicates that the content of the toxic and hazardous substances in all homogeneous materials of the component is below the limits specified in the GB/T26572 standard limit requirements below.

X means that the content of the toxic and hazardous substance in at least one of the homogeneous materials of the part exceeds the limit requirements stipulated in the GB/T26572 standard. Since there is no alternative at the moment, it complies with the EU RoHS standards.

### SERVICE

Thank you for your trust and support to our products, we will provide you with a two-year worry-free after-sales service (freight is not included), please do not alter this warranty service card, to safeguard your legitimate rights and interests. If you need service or have any questions, please consult the distributor or contact us.

Product quality problems occur within 24 months from the date of receipt, please prepare the product and the packaging, applying for after-sales maintenance in the site or store where you purchase; if the product is damaged due to personal reasons, a certain amount of maintenance fee shall be charged for repair.

We have the right to refuse to provide warranty service if:

- Products with damaged appearance, missing LOGO or beyond the service term
- Products that are disassembled, injured, privately repaired, modified or have missing parts
- The circuit is burned or the data cable or power interface is damaged
- Products damaged by foreign matter intrusion (including but not limited to various forms of fluid, sand, dust, soot, etc.)

### RECYCLING INFORMATION

All products marked with the symbol for separate collection of waste electrical and electronic equipment (WEEE Directive 2012/19 / EU) must be disposed of separately from unsorted municipal waste. To protect your health and the environment, this equipment must be disposed of at designated collection points for electrical and electronic equipment designated by the government or local authorities. Correct disposal and recycling will help prevent potential negative consequences for the environment and human health. To find out where these collection points are and how they work, contact the installer or your local authority.

### Declaration of conformity

Hereby, WENZHOU NOVA NEW ENERGY CO.,LTD declares that the radio equipment type ZSS-S01-GWM-C is in compliance with Directive 2014/53/EU, 2014/30/EU, 2011/65/EU. The full text of the EU declaration of conformity is available at the following internet address: <https://www.moestech.com/blogs/news/zss-s01-gwm-c>

### WARRANTY CARD

**Product Information**

Product Name: \_\_\_\_\_

Product Type: \_\_\_\_\_

Purchase Date: \_\_\_\_\_

Warranty Period: \_\_\_\_\_

Dealer Information: \_\_\_\_\_

Customer's Name: \_\_\_\_\_

Customer Phone: \_\_\_\_\_

Customer Address: \_\_\_\_\_

### Maintenance Records

Failure date	Cause Of Issue	Fault Content	Principal

Thank you for your support and purchase at we Moes, we are always here for your complete satisfaction, just feel free to share your great shopping experience with us.



If you have any other need, please do not hesitate to contact us first, we will try to meet your demand.

### FOLLOW US

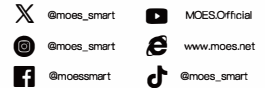

E-CrossStu-GmbH  
Mahnzer Landstr. 69, 60329 Frankfurt am Main  
Email: [crossstuf@web.de](mailto:crossstuf@web.de)  
Tel: +496933296764  
Made in China

EVATOST CONSULTING LTD  
Address: Suite 11, First Floor, May Road  
Business Centre, Tatts Wall, Cardiff,  
Wales, CF15 7QR  
Tel: +44292689945  
Email: [contact@evatost.com](mailto:contact@evatost.com)

WENZHOU NOVA NEW ENERGY CO.,LTD  
Address: Power Science and Technology  
Innovation Center, NQ238, Wei 11 Road,  
Yueqing Economic Development Zone,  
Yueqing, Zhejiang, China  
Tel: 86-577-57186815  
Email: [service@moeshouse.com](mailto:service@moeshouse.com)